

# Mechanical Dimensions

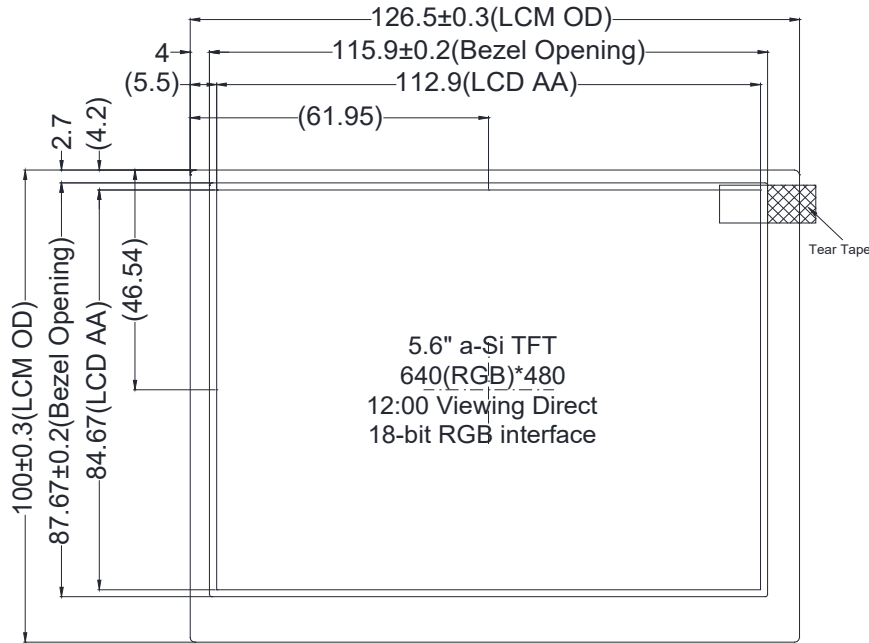

5.6" a-Si TFT  
640(RGB)\*480  
12:00 Viewing Direct  
18-bit RGB interface

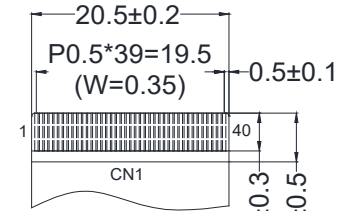
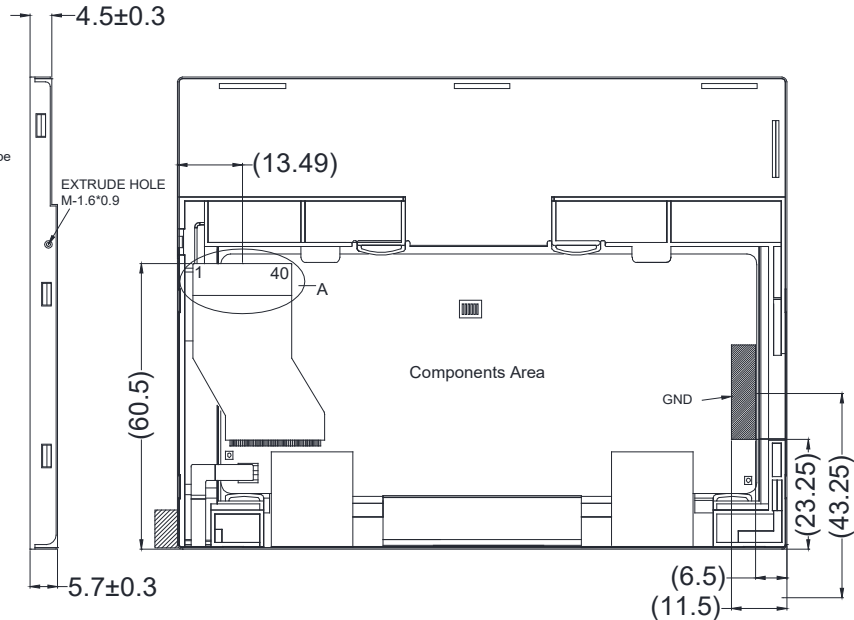

Connector: FH19SC-40S-0.5SH or Equivalent

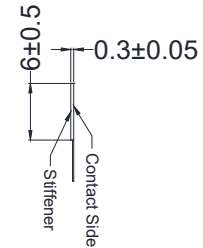

Pin	Symbol
1	VLED
2	VLED
3	ADJ
4	GLED
5	GLED
6	Vcc
7	Vcc
8	MODE
9	DE
10	VS
11	HS
12	GND
13	B5
14	B4
15	B3
16	GND
17	B2
18	B1
19	B0
20	GND
21	G5
22	G4
23	G3
24	GND
25	G2
26	G1
27	G0
28	GND
29	R5
30	R4
31	R3
32	GND
33	R2
34	R1
35	R0
36	GND
37	DCLK
38	GND
39	L/R
40	U/D

### Notes:

1. Display size: 5.6" TN TFT
2. Viewing direction: 12:00 O'Clock  
Colours inversion direction: 6:00 O'Clock
3. Display mode: Transmissive/Normal White
4. Operating temperature: -20°C~+70°C
5. Storage temperature: -30°C~+80°C
6. Backlight: White(21LEDs)/9.6V/140mA  
Brightness: 450 cd/m<sup>2</sup>(TYP)
7. Power supply voltage: 3.3V
8. RoHS compliant
9. General tolerance: ±0.3mm

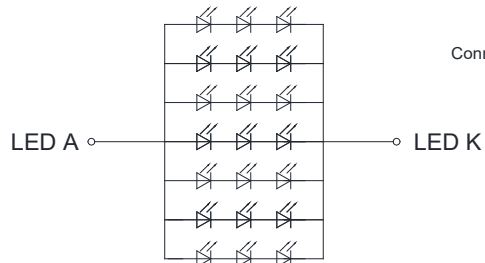

Backlight Circuit Diagram

**LOGIC TECHNOLOGIES**

Part Number	Revision
LTTD640480056-L2	A
	Not to scale. Unit mm.
Sheet: 1/1	